

















MONTAGEANLEITUNG

- | | | | |
|--|---------------------------------|---|------------------------|
|  | MONTAGEANLEITUNG |  | MONTAJ TALIMATI |
|  | ASSEMBLY INSTRUCTION |  | ASENNUSOHJE |
|  | DE INSTRUCTIE VAN DE ASSEMBLAGE |  | BRUGSANVISNING |
|  | ISTRUZIONI DI MONTAGGIO |  | BRUKSANVISNING |
|  | INSTRUCCIÓN DE ASAMBLEA |  | UPUTE ZA MONTAŽU |
|  | INSTRUCTION DE MONTAGE |  | NAVODILA ZA MONTAŽO |
|  | NÁVOD K MONTÁŽI |  | SZERELÉSI ÚTMUTATÓ |
|  | MONTERINGSANVISNING |  | INSTRUCTIUNI DE MONTAJ |



Modell-Nr.

12020

ART.-NR. FRONT KORPUS

12022	Rot (ähnl. RAL 3002)	Silber
-------	-------------------------	--------

12027	Ultramarinblau (RAL 5002)	Silber
-------	------------------------------	--------

12026	Silber	Schwarz (RAL 9005)
-------	--------	-----------------------

Friedrich Küpper GmbH
Friedrich-Küpper-Weg
54570 Berlingen
Deutschland

Telefon +49 (0) 65 91 - 95 42 0
Telefax +49 (0) 65 91 - 95 42 17
E-Mail info@friedrich-kuepper.de
Internet www.friedrich-kuepper.de

EINZELTEILE / PIECES

1× **A**



438 mm × 689 mm

Art.-Nr. E0450 (Silber/silver)
Art.-Nr. E0451 (Schwarz/black)

1× **B**



438 mm × 689 mm

Art.-Nr. E0452 (Silber/silver)
Art.-Nr. E0453 (Schwarz/black)

1× **C**



477 mm × 506 mm

Art.-Nr. E0454 (Silber/silver)
Art.-Nr. E0455 (Schwarz/black)

1× **D**



477 mm × 506 mm

Art.-Nr. E0456 (Silber/silver)
Art.-Nr. E0457 (Schwarz/black)

1× **E**



509 mm × 589 mm

Art.-Nr. E0458 (Silber/silver)
Art.-Nr. E0459 (Schwarz/black)

1× **K**



435 mm × 400 mm

Art.-Nr. E0460 (rot/red)
Art.-Nr. E0461 (Silber/silver)
Art.-Nr. E0462 (Blau/blue)

2× **V**



420 mm × 428 mm

Art.-Nr. E0463 (rot/red)
Art.-Nr. E0464 (Silber/silver)
Art.-Nr. E0465 (Blau/blue)

2× **N**



420 mm × 428 mm

Art.-Nr. E0466

2× **O**



Art.-Nr. E0467

2× **X**



450 mm × 20 mm

Art.-Nr. E0252

1× **P**



335 mm × 55 mm

Art.-Nr. E0468

1× **Q**

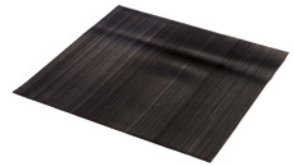

470 mm × 500 mm

Art.-Nr. E0469

BEUTELINHALT / BAG CONTENT



BENÖTIGTES WERKZEUG / NEEDED TOOLS

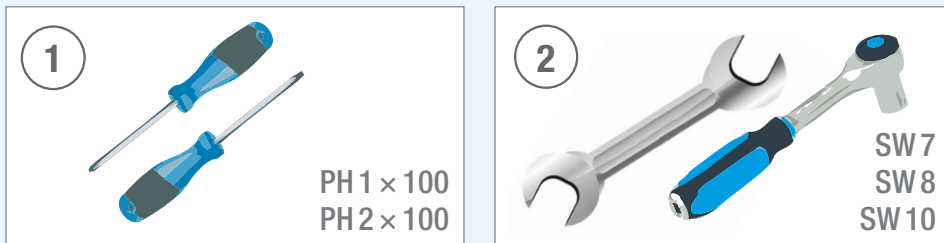

1.



2.



16x M6



16x M6 x 10



16x 6,4 mm



2x



2x



2x SW 10

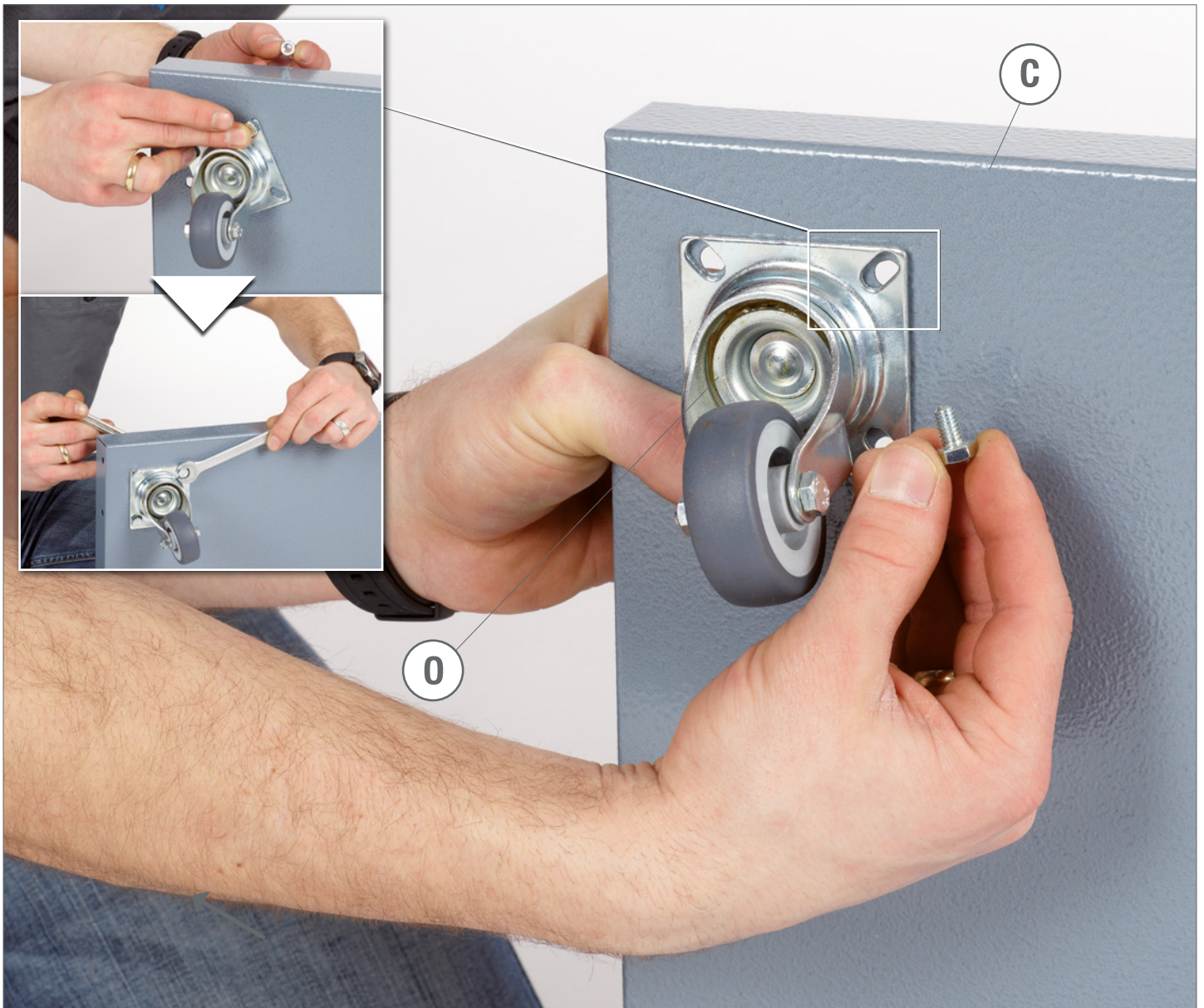

3.

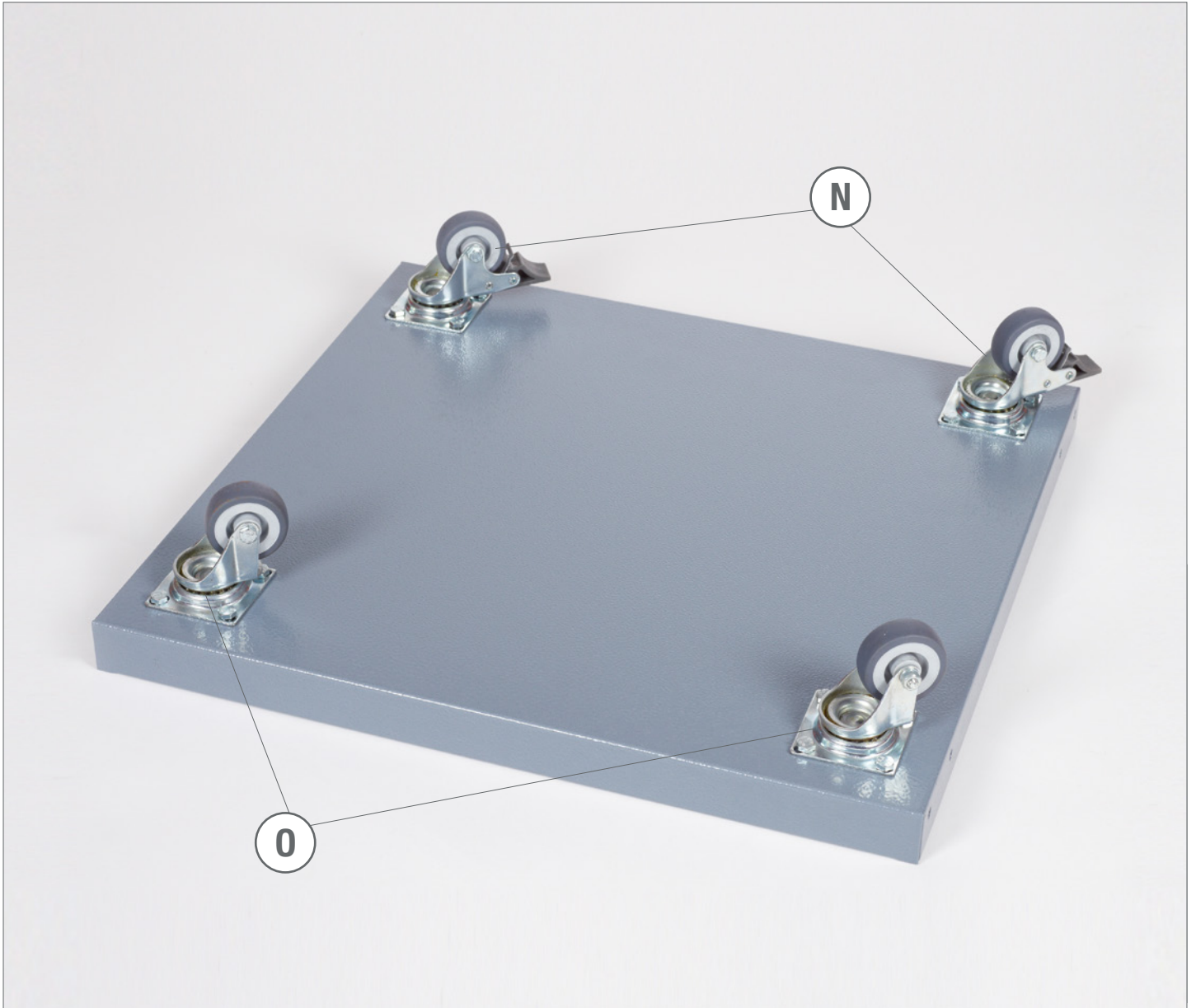

4.

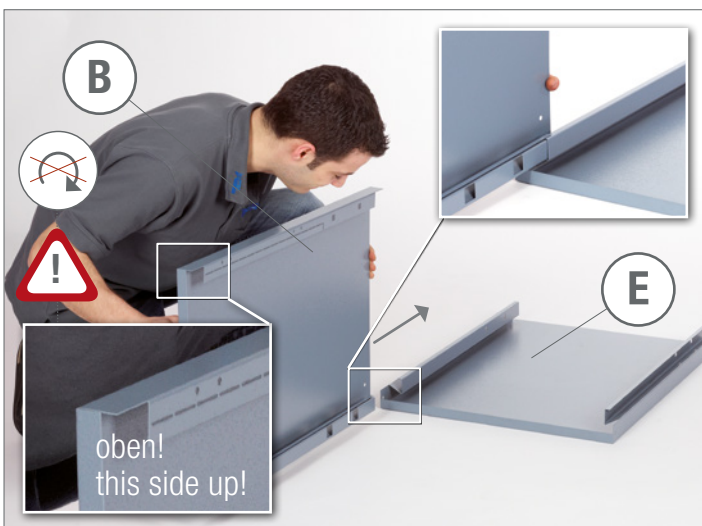

5.



6.



7.



8.



6× M5



6× M5 × 10



12× 5,3mm

②



SW 8

①



PH 2 100



9.



10.



11.

6 × M5 6 × M5 × 10 12 × 5,3 mm

② SW 8 ① PH 2 × 100



12.  2x CR



13.  2x CL



14.  2x DL

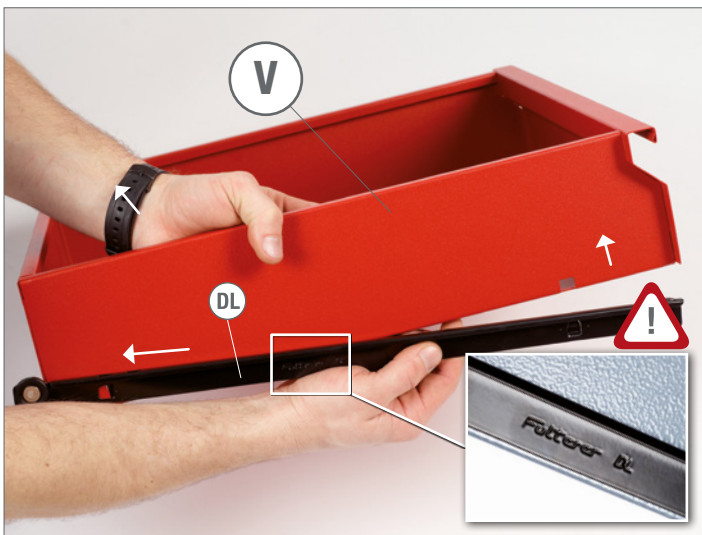

15.  2x DR

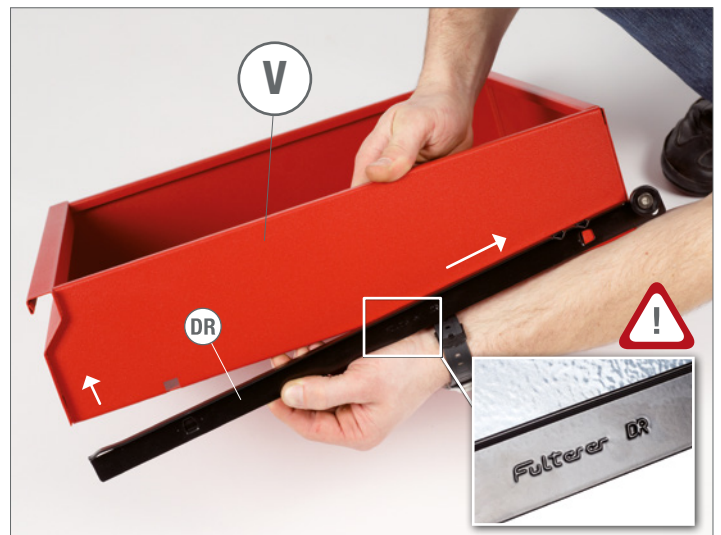

16.



17.



18.



19.



2x



4x M4



4x M4 x 10



SW7



PH1 x 100



20.



4x M4



4x M4x10

2



SW7

1



PH1x100



21.



1x



1x

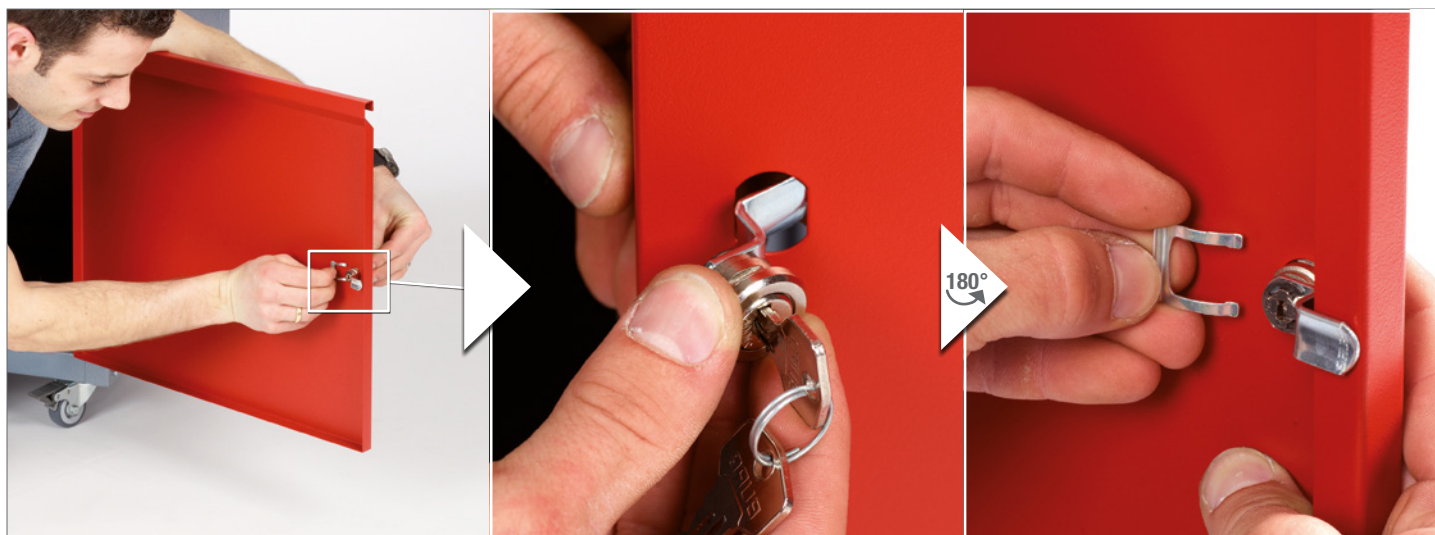

22.  2x M8



23.  4x 8mm  2x M8 x 25

②  SW 13





Modell-Nr.

12020